

Counterbore details,
for M10 and M8
bolts

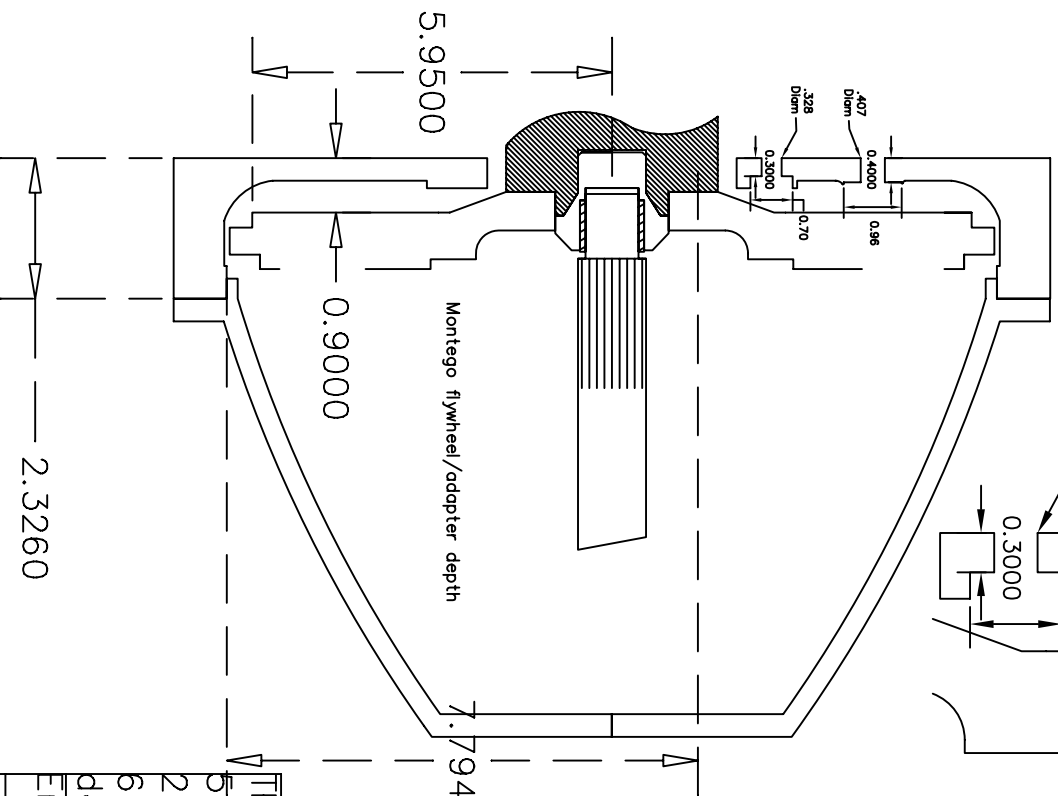

This is taken from my first set of measurements, the second box I measured had a different length mainshaft [.02inch longer], I have just found these dims on my scraps of paper I would suggest checking fit's and lengths yourself, all these dims are easy to measure. The flywheel shape is a sketch, the shape is more or less correct.

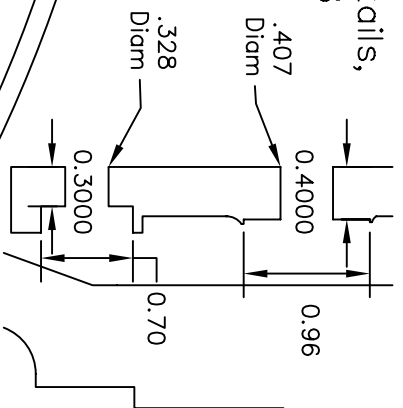
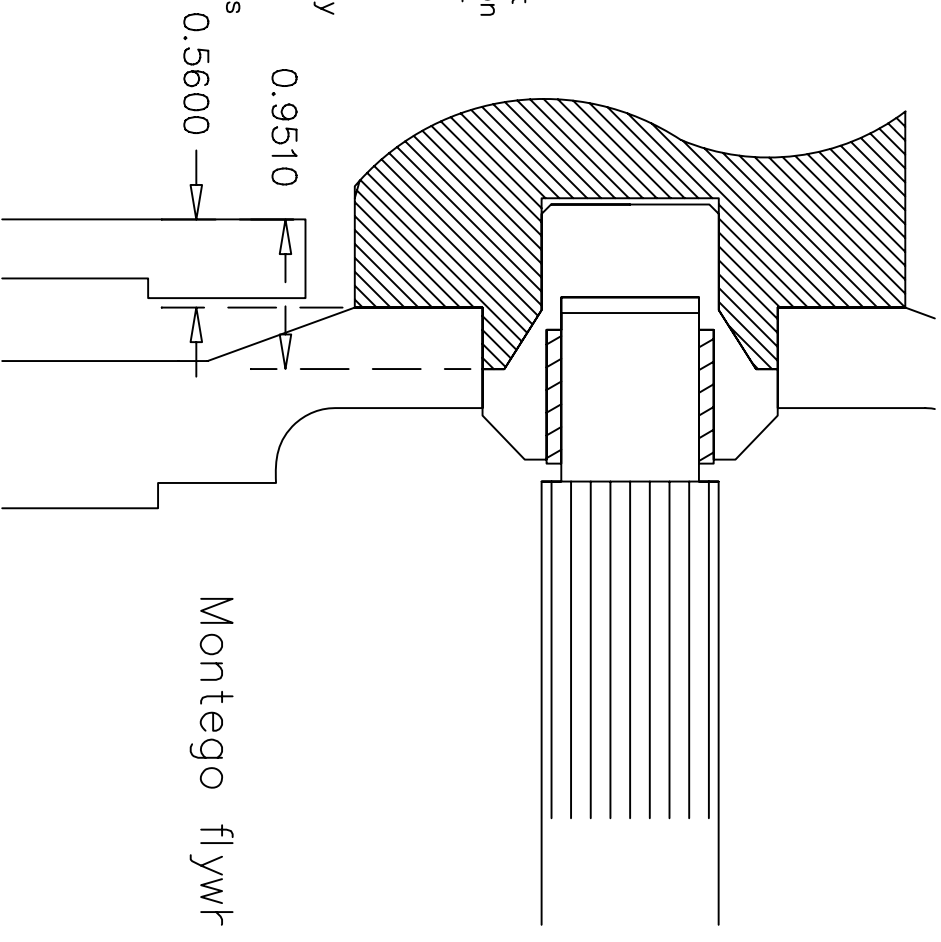

REVISIONS				
ZONE	REV	DESCRIPTION	DATE	APPROVED

This adapter is 59[mm] deep, mine is 2.416[inch] 61 [mm] which is the depth of Dudleigh Engineering adaptors.

IntegerSpin.co.uk
Prima flywheel landrover gearbox.

SIZE	FSCM NO.	DWG. NO.	REV
SCALE		Primafly01	
SHEET			